

## EA COUPLING MALE THREADED, DIN 3489 - VBA

ND	Inch	Thread DIN 2999	Material	Weight/pc Kg	Reference
15	1/2"	R 1/2	Stainless steel	0.15	EAMR013
20	3/4"	R 3/4	Stainless steel	0.16	EAMR019
25	1"	R 1	Stainless steel	0.22	EAMR025



Claw distance: 42 mm  
Working pressure: 10 bar / 145 Psi  
Profiled seal DIN 3489-D: FPM  
Male thread EN 10226-1 / DIN 2999, BSPT (not complying with DIN 3489)

## EA COUPLING FEMALE THREADED, DIN 3489 - VBI

ND	Inch	Thread EN ISO 228-1	Material	Weight/pc Kg	Reference
15	1/2"	G 1/2	Stainless steel	0.15	EAFR013
20	3/4"	G 3/4	Stainless steel	0.15	EAFR019
25	1"	G 1	Stainless steel	0.17	EAFR025



Claw distance: 42 mm  
Working pressure: 10 bar / 145 Psi  
Profiled seal DIN 3489-D: FPM  
Female thread EN ISO 228-1, BSP

## EA COUPLING WITH SERRATED HOSE SHANK, DIN 3489 - VB1

ND	Inch	For hose mm	Material	Weight/pc Kg	Reference
13	1/2"	13.0	Stainless steel	0.17	EASKR013
19	3/4"	19.0	Stainless steel	0.19	EASKR019
25	1"	25.0	Stainless steel	0.24	EASKR025



Claw distance: 42 mm  
Working pressure: 10 bar / 145 Psi  
Profiled seal DIN 3489-D: FPM  
Assembly: two bolt saddle clamps, worm drive clamps

## EUROPEAN AIR COUPLINGS



### EA COUPLING CAP, DIN 3489 - VB

Material	Weight/pc Kg	Reference
Stainless steel	0.14	EAKR

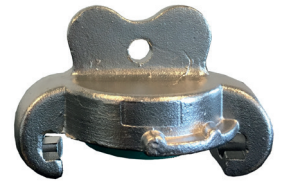

Claw distance: 42 mm

Working pressure: 10 bar / 145 Psi

Profiled seal DIN 3489-D: NBR standard

## SEAL

### PROFILED SEAL DIN 3489-D

Material	Colour	OD mm +0.1 / -0.2	ID mm	Height +0.2 / -0.1	Box pieces	Weight kg	Reference
NBR	black	34.0	20.0	11.0	50	0.006	EAX
FPM	green	34.0	20.0	11.0	50	0.006	EAXV

